

BRUNTON

RESIDENTIAL



WOODCROFT ROAD, WYLAM

£1,400 Per Month

BRUNTON

RESIDENTIAL





BRUNTON

RESIDENTIAL



BRUNTON

RESIDENTIAL



Available Now - Rent £1,400pcm - 4 Bedroom - Semi Detached - Unfurnished - Well Presented - EPC C - Call Today

Nestled on the charming Woodcroft Road in the picturesque village of Wylam, this delightful semi-detached house offers a perfect blend of comfort and style. With four spacious bedrooms, this property is ideal for families seeking a welcoming home in a tranquil setting.

This semi-detached house on Woodcroft Road is not just a property; it is a place where memories can be made and cherished. With its appealing features and prime location, it presents a wonderful opportunity for anyone looking to settle in this delightful village. Do not miss the chance to make this house your home.

BRUNTON

RESIDENTIAL



BRUNTON

RESIDENTIAL



BRUNTON

RESIDENTIAL

TENURE :

LOCAL AUTHORITY : Northumberland

COUNCIL TAX BAND : E

EPC RATING : C

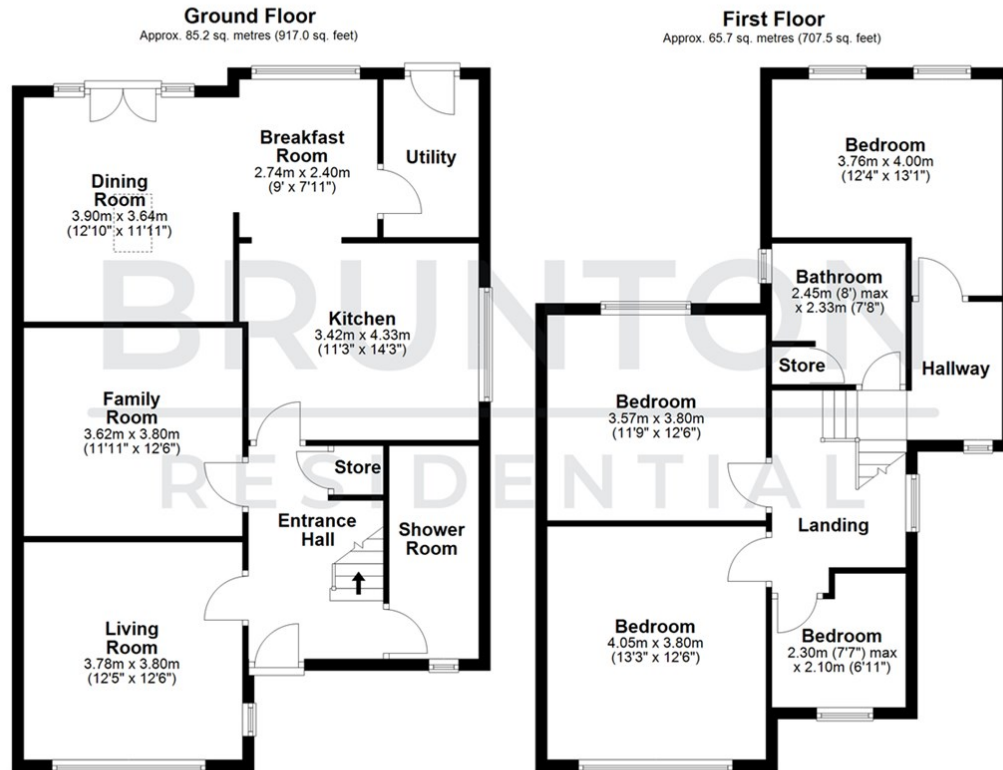

Total area: approx. 150.9 sq. metres (1624.5 sq. feet)

